

# ASHLAND

ENERGY WISE HOME

OVERALL DIMENSIONS

41'-8" x 64'-0"



The garage and bedroom extend from the front of this three bedroom home, drawing you visually into the entryway. Brick and stucco are used to further enhance these different depths. Arched openings and columns add an artistic and classical flair. This same attention to detail is seen on the inside of the home. Columns create a sense of elegance, while tray ceilings add definition and character.

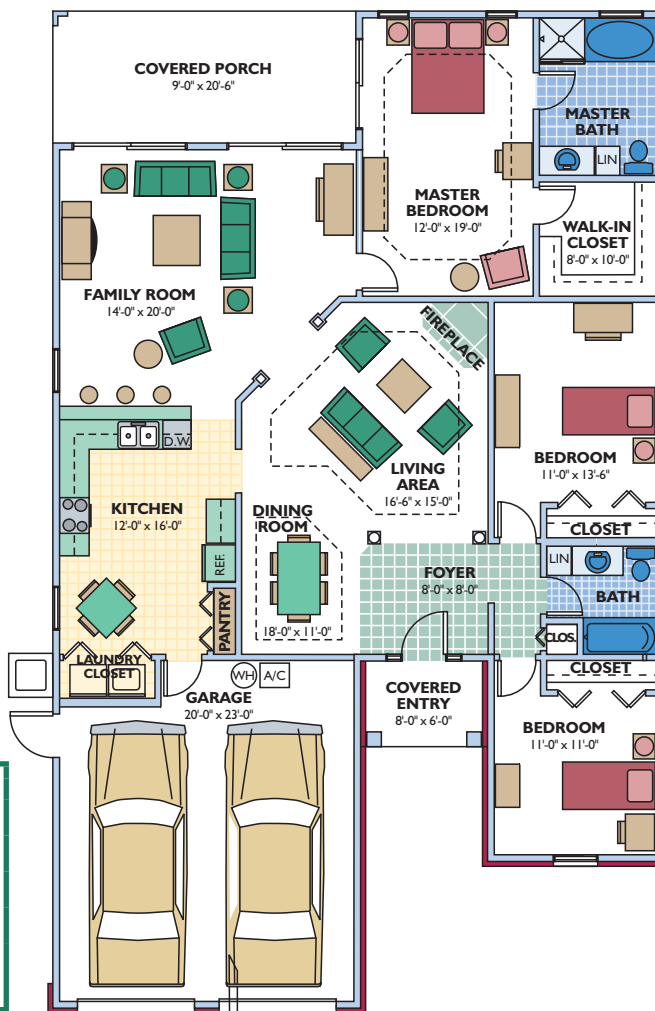

Eco-Smart offers a complete line of pre-cut and pre-engineered home and building packages utilizing structural insulated panel technology (SIPs). All packages erect quickly, are stronger than conventional framing and extremely energy efficient. SIPs can be clad in conventional OSB or in steel incorporating the patented Snap-N-Lock panel connection.

### Snap-N-Lock™ Insulated Panel

Your Choice of Aluminum or Steel Skins

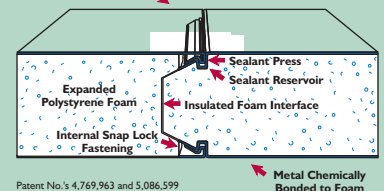

### Dual Plywood Spline Joint

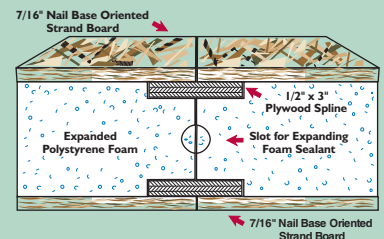

<b>Living Area</b>	1825 sq. ft.
<b>Garage</b>	497 sq. ft.
<b>Entry</b>	49 sq. ft.
<b>Porch</b>	186 sq. ft.
<b>TOTAL</b>	2557 sq. ft.

3 bedroom, 2 bath  
2 car garage

Plans and specifications are subject to change without notice. All dimensions are approximate.