

COQUINA

ENERGY WISE HOME

OVERALL DIMENSIONS

75'-0" x 58'-0"



The most asked for features are all found in this three bedroom, two bath home. The foyer offers both privacy and style. Natural light floods the living area through the large sliding glass doors. The kitchen has enough room for all the cooks of the house, with both an island and pantry. A large utility room adjoins the kitchen. The master bedroom is really a suite all to itself, with a full-size walk-in closet and bath complete with a relaxing spa tub.

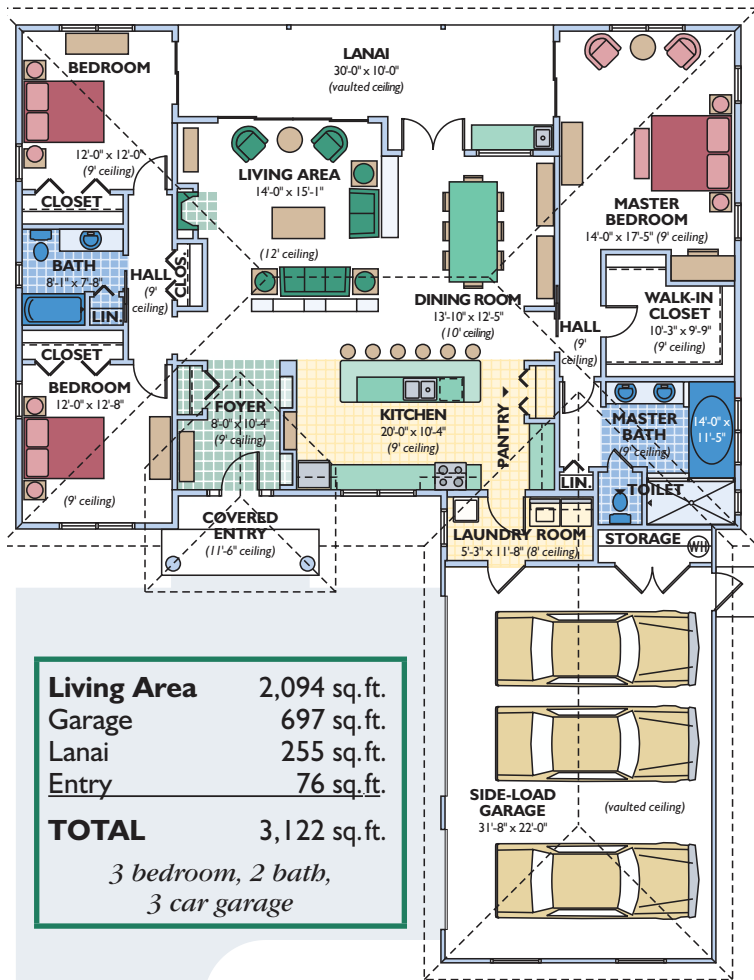

Eco-\$mart offers a complete line of pre-cut and pre-engineered home and building packages utilizing structural insulated panel technology (SIPs). All packages erect quickly, are stronger than conventional framing and extremely energy efficient. SIPs can be clad in conventional OSB or in steel incorporating the patented Snap-N-Lock panel connection.

Snap-N-Lock™ Insulated Panel

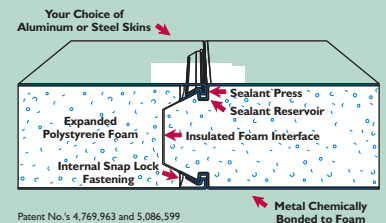

Dual Plywood Spline Joint

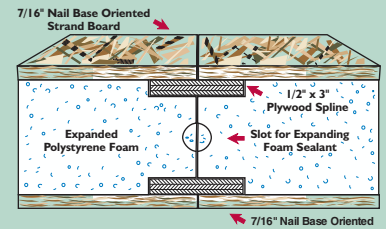

Plans and specifications are subject to change without notice. All dimensions are approximate.

ECO-\$MART, INC

TOLL FREE:(888)329-2705 info@eco-smart.com www.eco-smart.com